

2

1

PARTS LIST

ITEM	PART #	ITEM QTY	PART NUMBER
1	TS-1B	1	Back Bone
2	TS-1FP	1	Fixed Pin Plate w/o TS-1P pins and attachment hardware
2A	TS-1FPA	1	Fixed Pin Plate with (48) TS-1P pins installed and attachment hardware included
3	TS-1AP	1	Action Pin Plate w/o TS-1P pins
3A	TS-1APA	1	Action Pin Plate with (48) TS-1P pins installed
4	TS-1P	96	Pin Turf Stretcher rev
5	TS-1H	1	Handle
6	TS-1G	1	Spur Gear
7	TS-1GF	2	Hex Bolt 1/4-20 x 3/4 w/ Lock Washer
8	TS-1HP	1	Handle Pivot Pin
9	TS-1HW	2	3/4 Flat Washer

CAUTION:

Prior to each use, the operator must inspect all pins to ensure they are not bent, damaged or loose. All repairs must be made prior to use. The fasteners used to attach the handle to the spur gear must also be checked to ensure that they are properly tightened.

B

B

A

A

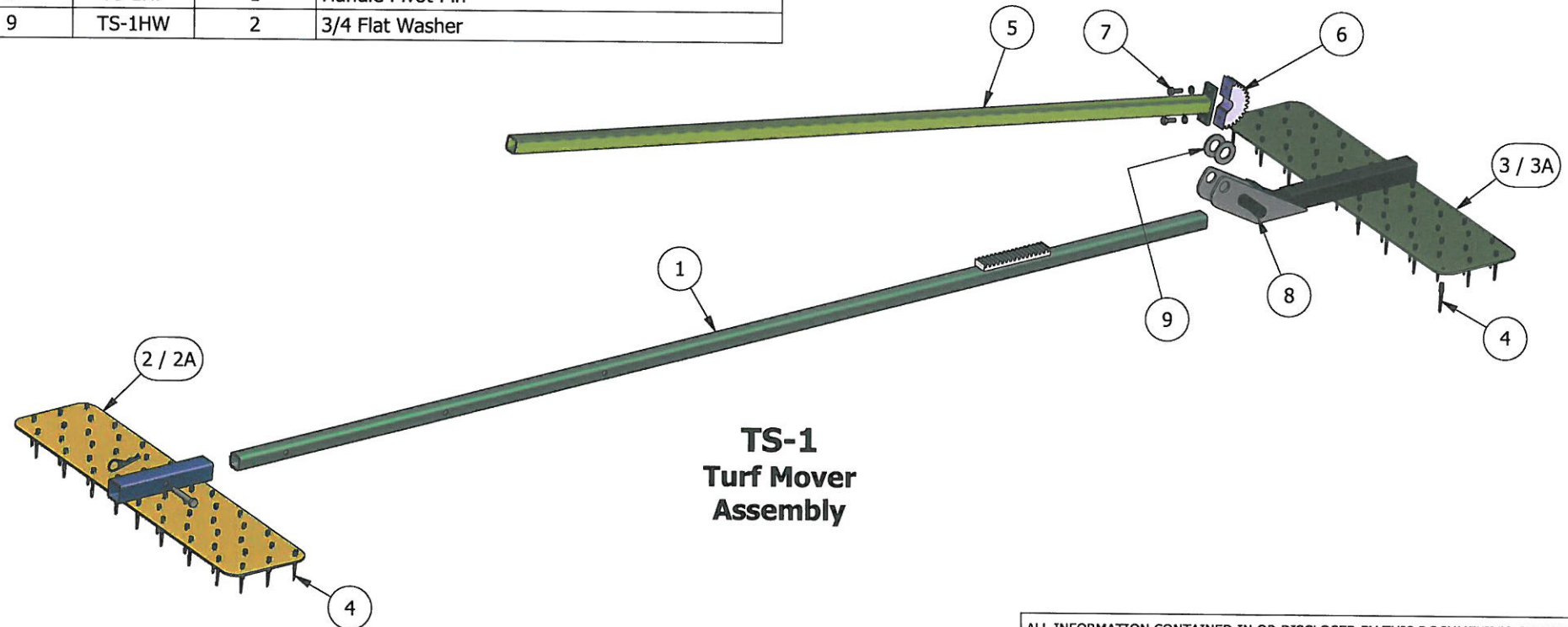

**TS-1
Turf Mover
Assembly**

ALL INFORMATION CONTAINED IN OR DISCLOSED BY THIS DOCUMENT IS CONSIDERED CONFIDENTIAL AND PROPRIETARY BY TISI. ALL DESIGN, MANUFACTURE, USE, PRODUCTION, AND SALES RIGHTS ARE RESERVED BY TISI.

DRAWN Jason H			TEXTILE & INDUSTRIAL SALES, INC. DALTON, GA 30721 USA	
DRAWING STATUS Parts Only			TITLE TS-1 Turf Mover Assy Parts Drawing	
DRAWING SHEET 1 of 1		PROJECT		
CREATED ON 9/13/2013	SIZE A	SCALE DO NOT SCALE	DRAWING NUMBER TS-1 Parts	REV 0

REVISION HISTORY

ZONE	REV	DESCRIPTION	DATE	APPROVED
	0	Initial Release	9/13/2013	JLH

2

1