

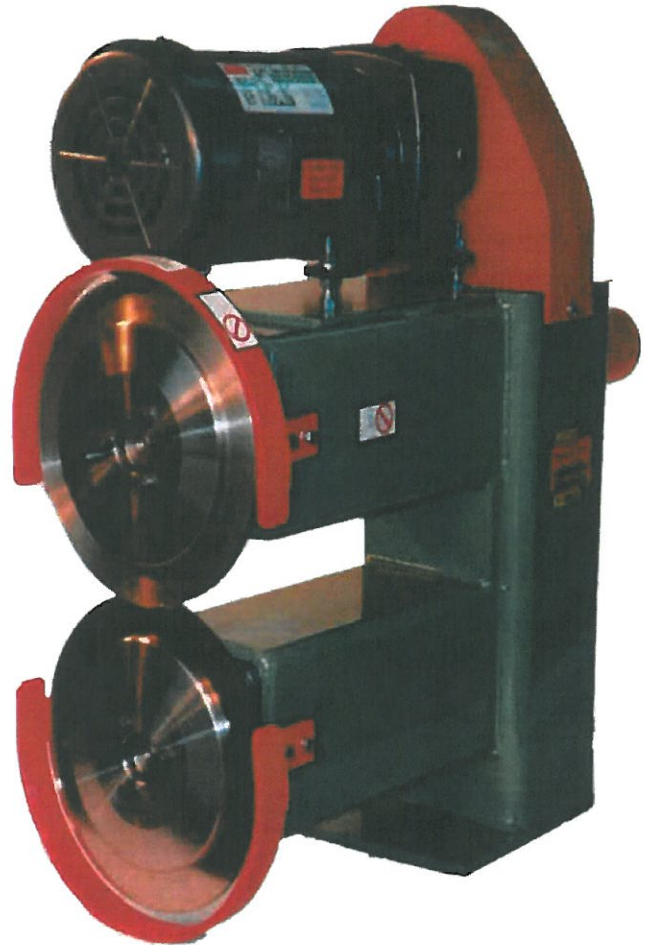

610D-2BD Trimmer

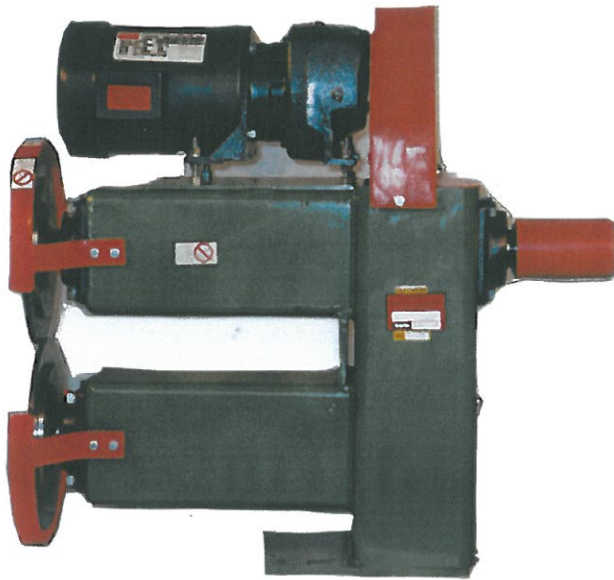

The model 610 trimmer is designed for edge trimming backed carpet on high speed finishing lines. The 610 is based on a scissors action principle of cutting. Both 9 7/16 inch blades are positively driven. The blades are hardened throughout to give superior life and cutting characteristics. Blades can be sharpened 20-30 times or until too thin for use. The motor is a 3/4 hp gearmotor. Different rpm output speeds are used to match the blades circumference speed to the fastest line speed.

Mounting can be in any position necessary for material flow. Trolleys are available to mount on 6" 20 lb. or 6" 25 lb. beams. Without the trolley, the 610 trimmer weighs 240 lbs. The model 610 trimmer will provide reliable trimming for heavy products.

Textile And Industrial Sales, Inc.

404 Whitener Drive

Dalton, Georgia 30720

Phone (706) 226-2102

Fax (706) 278-1734

Email tisi@alltel.net

Visit our Website: www.trimsew.com

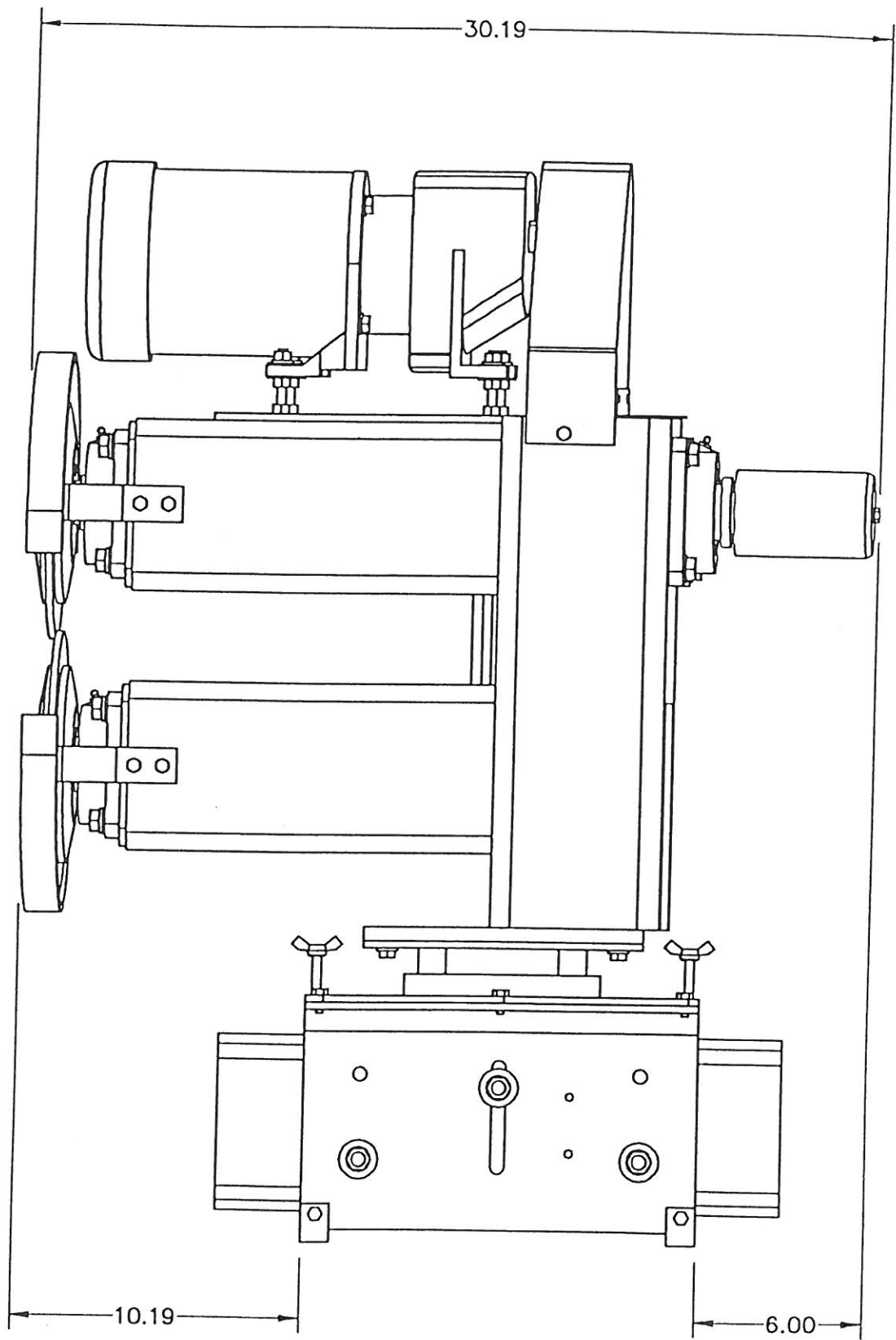

610 LEFT HAND TRIMMER ON A
6" RIGID TROLLEY WITH THE SAME
CUT LINE AS A 601 ON A 6" SHORT
BLOCK SWIVEL TROLLEY

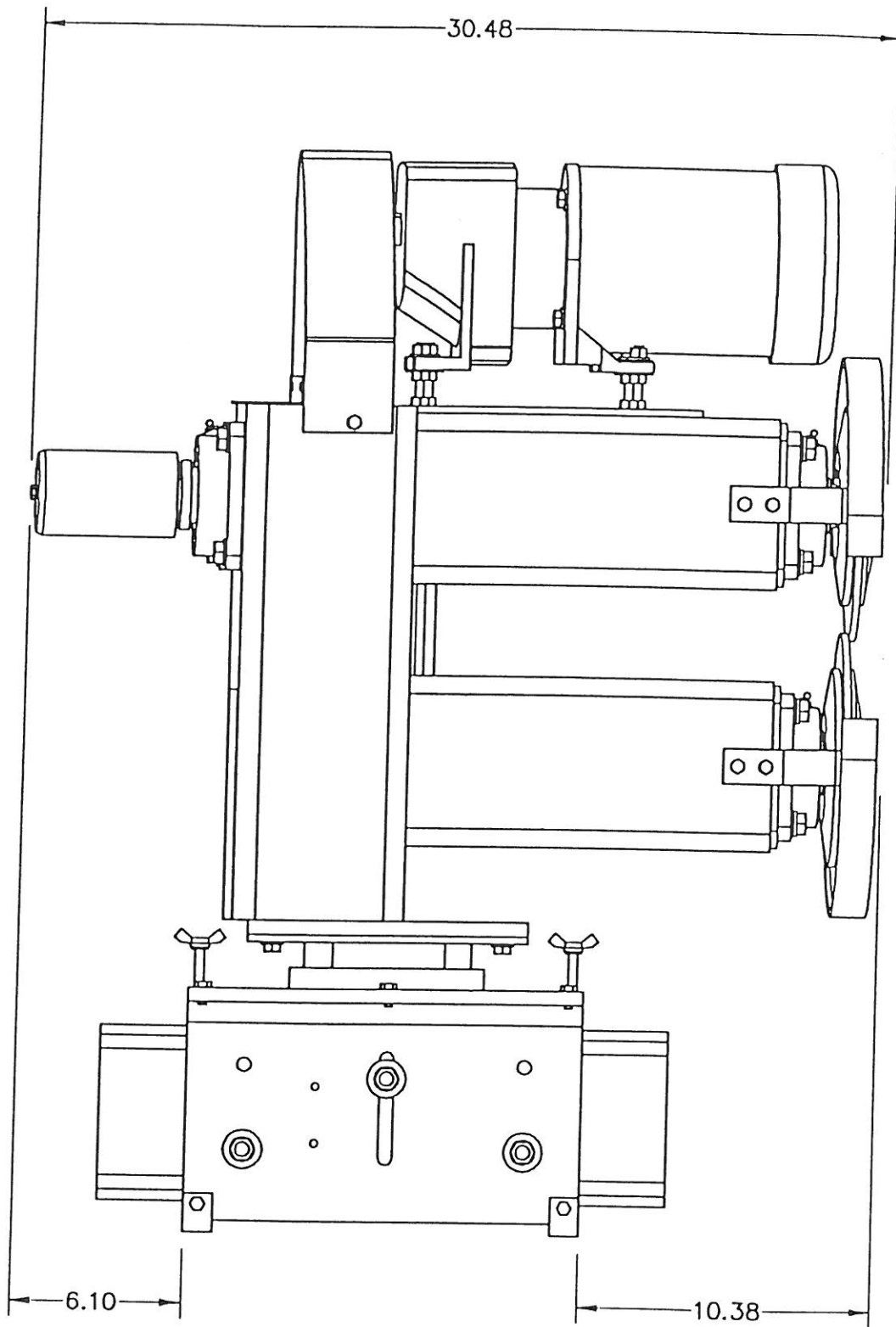

610 RIGHT HAND TRIMMER ON A
6" RIGID TROLLEY WITH THE SAME
CUT LINE AS A 601 ON A 6" SHO
BLOCK SWIVEL TROLLEY

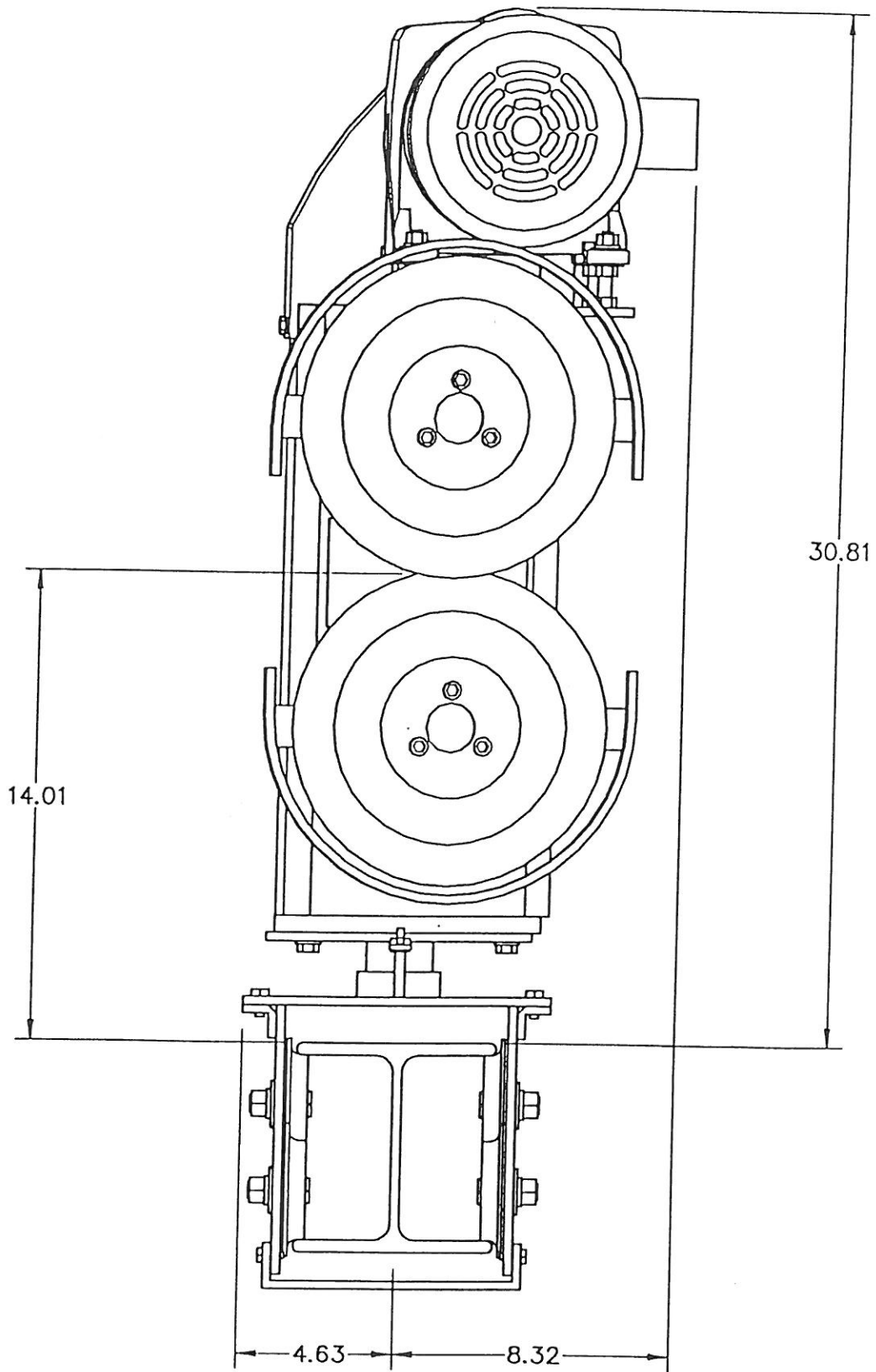

610 RIGHT HAND TRIMMER ON A
6" RIGID TROLLEY WITH THE SAME
CUT LINE AS A 601 ON A 6" SHORT
BLOCK SWIVEL TROLLEY